

DETALIU CAPAC ACCES POMPE STATIE POMPARE INFLUENT
SCARA 1:10

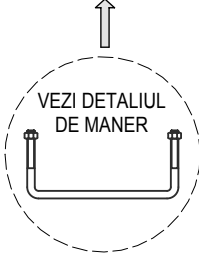

Nr.	Element	Dimensiuni (mm)	Greutate/ml (kg/mp)	Greutate totala (Kg)
1	Cornier L80x80x6	7.000	9.6	67.20
2	Tabla striata cu gr. de 6mm	1.160x760	52.10	46.00
Nota: Toate elementele metalice se vor fi galvaniza.				46.00

DETALIU MANER
Scara 1:10

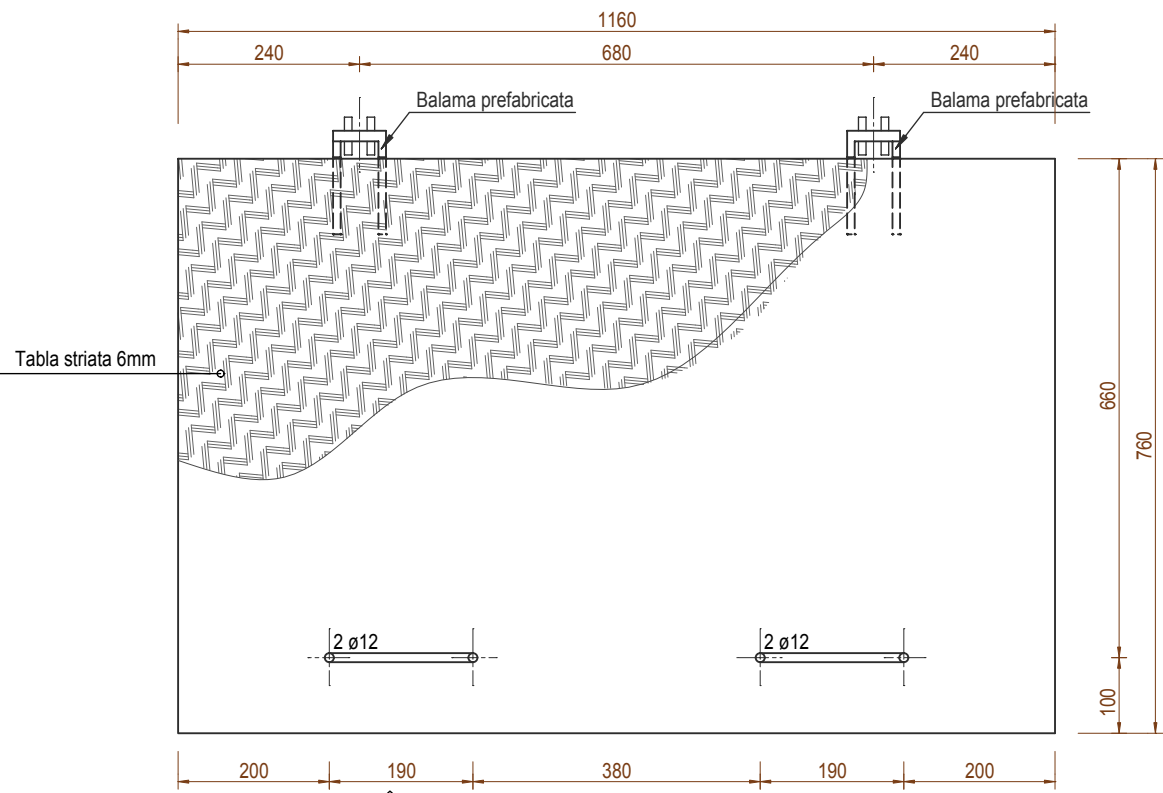
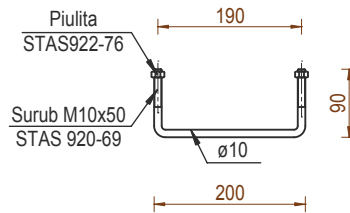

Nr.	Element	Dimensiuni (mm)	Greutate/ml (kg/mp)	Greutate totala (Kg)
1	Cornier L80x80x6	9.500	9.6	91.20
2	Tabla striata cu gr. de 6mm	1.760x760	34.00	45.60

Nota: Toate elementele metalice se vor fi galvaniza.

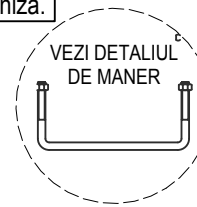

DETALIU CAPAC ACCES COS GRATAR
STATIE POMPARE INFLUENT
SCARA 1:10

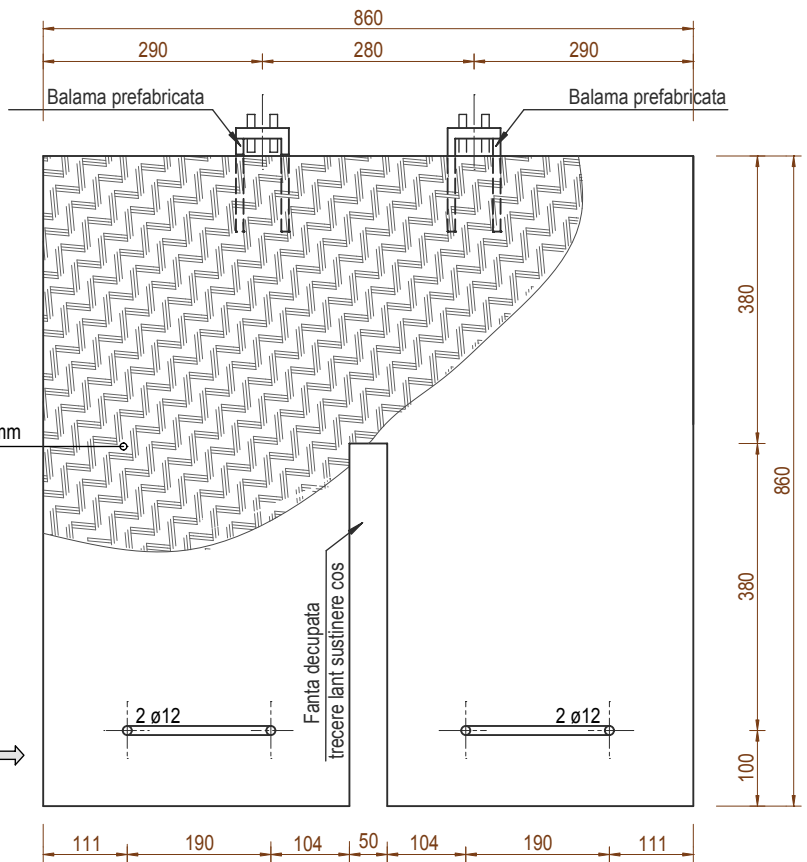

DETALIU CADRU PENTRU CAPAC ACCES COS GRATAR
STATIE POMPARE INFLUENT
SCARA 1:10

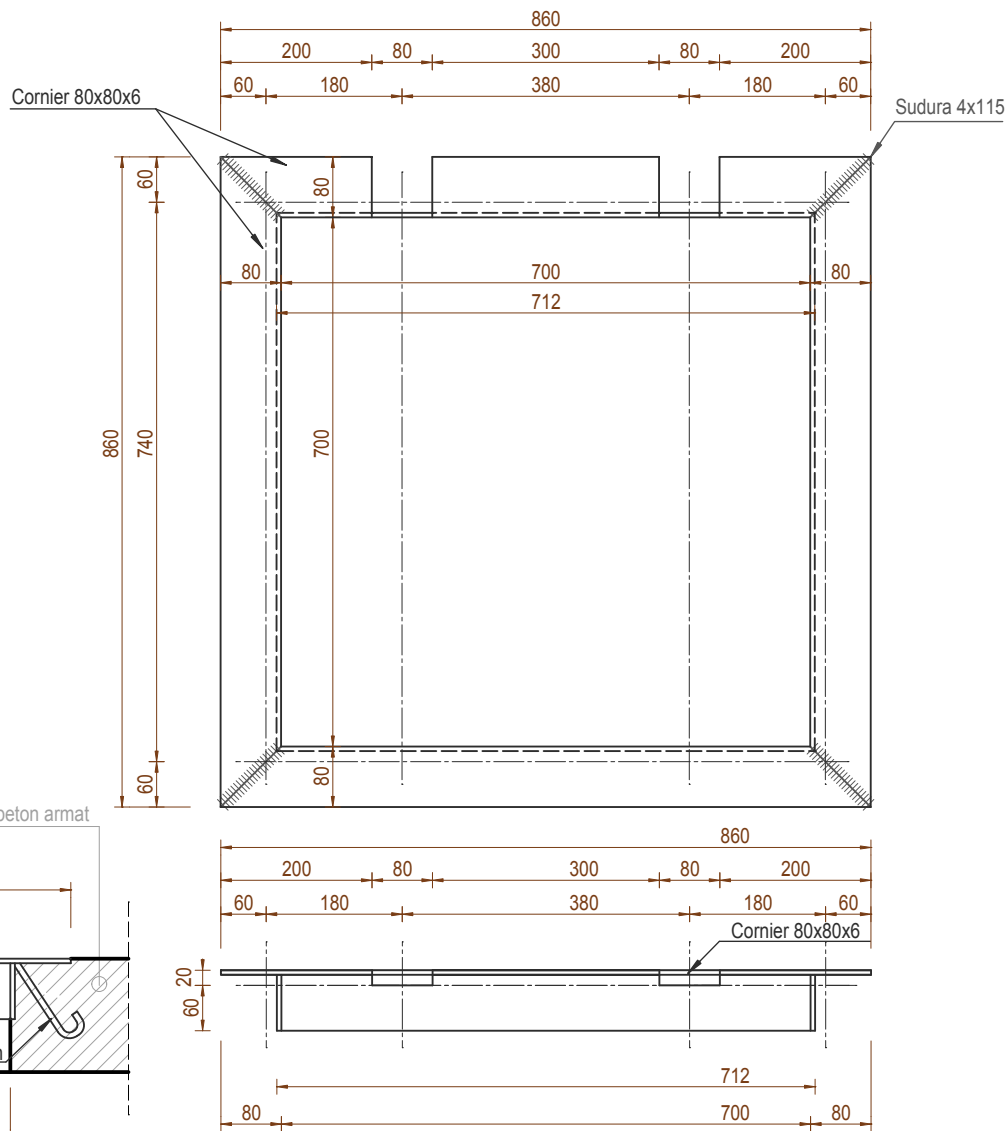

DETALIU CADRU PENTRU CAPAC POMPE
STATIE POMPARE INFUENT
SCARA 1:10

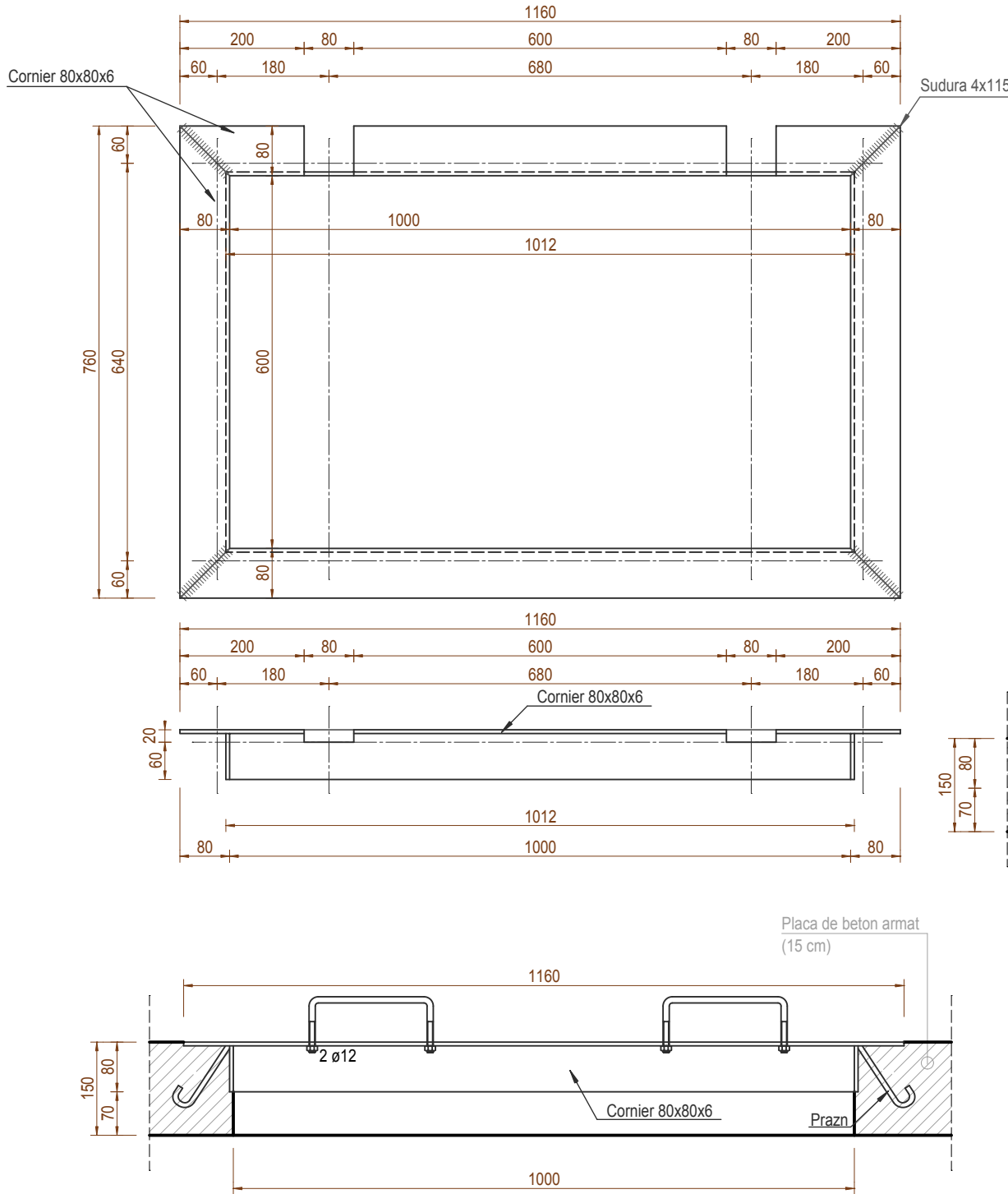

Nota: Inainte de turnarea betonului se vor monta in cofraj toate piesele metalice (praznuri, piese de trecere, piese instalatii, etc).

Nota: Pentru detalii placa prefabricata pentru statie pompare influent consultati desenu SE-C1

Verificator/expert	Titlu / Nume	Semnatura	Cerinta	Referat / Expertiza nr / Data	Pr.nr.: 18/2015
S.C. PANMITI CON S.R.L. CUI RO 10110990, J18/9/1998, Mun. Tg.-Jiu, Str. Alea Ioan Slavici, Nr.3, Bl.3, Sc.1, Ap.1, Jud. Gorj				Beneficiar: COMUNA CAPRENI	
				Amplasament: COMUNA CAPRENI, JUD. GORJ	
Specificatie	Titlu / Nume	Semnatura	Scara 1:10	Titlul proiectului: CONSTRUIRE CANALIZARE SI STATIE DE EPURARE APE UZATE, COMUNA CAPRENI, JUDETUL GORJ	Faza: P.T.
SEF PROIECT	ing. Fintina Adrian				
PROIECTAT	ing. Vladioiu Gheorghe				
DESENAT	ing. Vladioiu Gheorghe				
				Data: 11/2015	Pl. nr.: SE - D2
				Titlul plansei: PLAN DETALIU CAPACE ACCES PLACA ACOPERIS STATIE POMPARE INFLUENT	